



No Adapters Needed

The SmartPlug Dual Configuration cordset was designed to protect the boatside end of the shore power connection first, while allowing for integration with older twist-type connections on the marina end.



Weatherproof

Water intrusion leads to corrosion, and corrosion leads to electrical arcing and overheating. The SmartPlug's weatherproof face seal on the boatside end eliminates moisture intrusion.



Sleeved Design

One of the primary causes of failure in the old twist-type design is that the electrical pins bear any weight or tension in the cord. This is of greatest concern on the boatside end of the cable where most of the movement occurs as the boat rocks and drifts around. The SmartPlug connector's sleeved body bears that tension rather than the electrical pins, keeping those points of electrical contact secure.



Multi-Point Locking System

Locking side levers on the connector combined with the SmartPlug Inlet's locking cap ensure a rock solid connection on the boatside end.



Tinned Copper Wire

SmartPlug Cordsets are the first to use tinned copper wire (10/3) for the ultimate in corrosion resistance and durability.



Power-On Indicator Light

An LED light on the boatside connector illuminates bright blue letting you know when power is present to the boat. If it's off, you know that it's safe to disconnect the shore power cable from the boat.



Easy to Use

Simply push the boatside connector straight in until the side levers 'click' and then snap the locking cap down to finish the job. It can only be plugged in one way, so no more struggling to find the correct alignment.

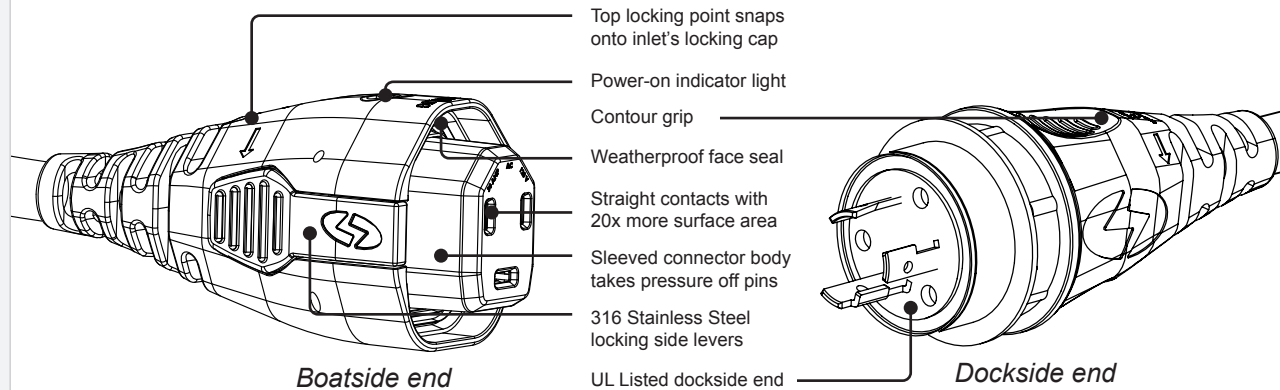
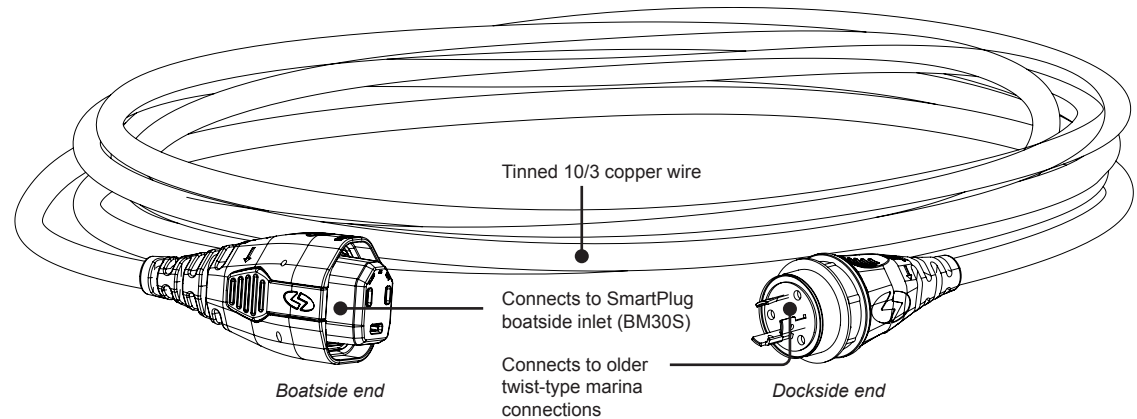

2288 W. COMMODORE WAY
SUITE 300
SEATTLE, WA 98199
TEL: 206.285.2990
FAX: 206.285.2981

Specifications v1.0

25' model: C30253
50' model: C30503

WWW.SMARTPLUG.COM

Exterior metal materials 316 Stainless Steel	Electrical contacts materials Nickel-Plated Brass	Testing & Certification Boatside end ABYC E-11 compliant Dockside end UL Listed Cord - UL Listed	<p>MEMBER ABYC Setting Standards for Safer Boating E-11 Compliant</p>
Exterior overmold materials UV/Impact resistant PVC	Wire conductor materials Tinned Copper 10/3 Wire	7 Year warranty (see website)	
Interior housing material UV/Impact resistant ABS	25-foot length specifics 25ft/7.62m part# C30253	Assembled in the USA	<p>7 YEAR WARRANTY</p>
Weatherproof face gasket material Silicone Rubber	50-foot length specifics 50ft/15.24m part# C30503		

30
AMP/125V



SMARTPLUG

Shore Power

Dual Configuration Cordset Frequently Asked Questions

Models C30503 & C30253

August, 2010

Here's how it works

1

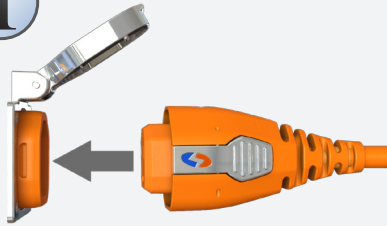

Push connector straight into inlet
No Twisting Required!

2

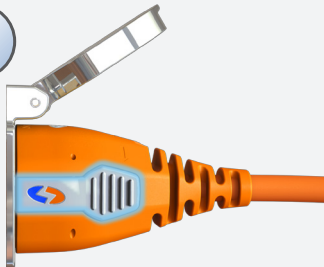

Stainless Steel side levers lock
connector into place

3

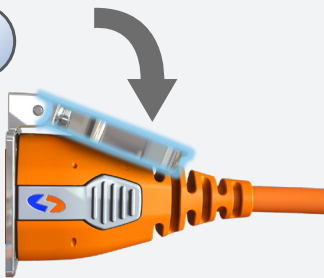

Stainless Steel cover snaps down
onto rear of connector

Frequently Asked Questions

What is the SmartPlug and why do I need it?

The SmartPlug is a revolutionary new shore power system designed to replace the outdated and problematic twist-type design in use today. It's intuitive to use and provides greater protection against loose connections and corrosion - the leading causes of shore power failure and fires.

Does my marina have to upgrade to SmartPlug before I can use it?

No! The marina DOES NOT need to be converted to the SmartPlug for you to be able to **protect your boat now!** The SmartPlug Dual Configuration Cordset along with a SmartPlug Inlet gives you everything you need to fix the **boatside** end of the shore power problem (the end you most care about!) now.

Do I need any adapters to use the Dual Configuration Cordset?

No! Simply install a SmartPlug 30 Amp Inlet on your boat and plug the SmartPlug end of the cordset into it. The dockside end of the cord connects directly to the older twist-type marina connections.

Is the SmartPlug Cordset compliant with any safety regulations?

The SmartPlug cordset is fully ABYC E-11 and US Coast Guard compliant.

What materials are used in the SmartPlug?

Only the finest materials are used in construction of SmartPlug products. All external metals are Marine-Grade 316 Stainless Steel and the plastics are UV and heat resistant ABS and PVC. And last but certainly not least... tinned copper wire is used throughout the entire length of the cordset for the ultimate in corrosion resistance.

Why do SmartPlug cordsets use tinned copper wire?

The use of tinned copper wiring is recommended by many marine industry experts and is considered a premium for its resistance to corrosion. It also lasts up to 10x longer than non-tinned wire and provides enhanced conductivity, further extending the life of the cordset.

How do I know when my old twist-type connection is showing signs of failure?

The beginning signs of failure can be very slight so you should frequently inspect your connector and inlet for discoloration of the electrical contacts and surrounding plastic. Corrosion and pitting typically appear as green or black dots on the electrical contacts and result in a rise of resistance and heat. If not addressed early, the problem can quickly worsen and cause scorching, melting and in the worst of cases, fire.

SmartPlug Products



30A Inlet and Connector B30ASSY

Everything you need to fix the boatside end of the shore power problem right now.



30A Inlet BM30S

Replaces the old-style inlet on your boat. Mounts using the typical 4-hole pattern.



30A Connector BF30

Replaces the connector on the boatside end of your existing shore power cordset.



30A Dual Configuration Cordset

C30253 (25') & C30503 (50')
SmartPlug connector on the boatside with twist-type plug on the dockside.



Weatherproof Cover A1001 - *Coming soon*

Protects SmartPlug boatside connectors from moisture when not in use.



50A Products *Coming soon*

A complete line of shore power products for 50 Amp applications.



www.smartplug.com